

PROJECT: Land to the north-west of Westhide, Herefordshire, HR1 3RQ (Ref: P214619/F)

CLIENT: Ersun (Westhide SPV) Ltd

Date: 24th October 2022

Landscape and Visual Impact Assessment Addendum: Amendments to Landscape Proposals

Introduction

This addendum provides an update on landscape and visual matters in respect of amendments made to the Masterplan and Landscape Mitigation and Enhancement Plans submitted with the planning application (Ref: P214619/F). It is in response to comments received from officers at Herefordshire Council.

The amended drawings are included at the end of this note, which include the following:

3352_L_GA_0_01 Masterplan Rev O

3352_L_GA_0_02 Landscape Mitigation and Enhancement Plan Rev E

3352_L_GA_1_01 Landscape Mitigation and Enhancement Plan Inset 1 Rev B

3352_L_GA_1_02 Landscape Mitigation and Enhancement Plan Inset 2 Rev B

3352_L_GA_1_03 Landscape Mitigation and Enhancement Plan Inset 3 Rev B

3352_L_GA_1_04 Landscape Mitigation and Enhancement Plan Inset 4 Rev A

Amendments to proposals

Removal of panels

Based on further feedback from the Herefordshire Council in regards to the use of Best and Most Versatile (BMV) land for solar PV instead of food crops, it was agreed that panels would be removed from those fields that consisted predominantly of higher-grade agricultural land. Panels have therefore been removed from fields A, D, E, H and I. Proposed mitigation measures for the scheme have been amended accordingly to reflect the reduction in the extent of the array, which are shown on the accompanying drawings and as outlined below:

Fields A, D and E:

Proposed tree planting along the western boundary of Field A has been removed, as there is no longer a need to filter views of this field from the west. Tree planting to the eastern boundary of Field A and southern boundary of Field D has been retained to create a layering of vegetation, in combination with tree planting along the western and northern boundary of Field D. This is to assist in filtering views of the development in Fields C and F when views from the road to the south and from Westhide to the south-west.

Along the boundary between Fields D and E, the previously proposed hedgerow alongside the existing tree planting has been retained as part of the scheme to reinstate the historic field boundary and to enhance connectivity of natural features, including the isolated woodland block along this boundary. Similarly, the hedgerow has been retained along the eastern boundary of

Field E, restoring the historic field boundary and connecting the woodland belt with the vegetation along the stream to the south. Any additional tree planting along these boundaries have been removed as there is no longer a need to filter views of the development in Field E from viewpoints to the west.

Fields H and I:

The previously proposed tree planting along the eastern and western boundaries of Field I have been retained. The density of tree planting has been reduced slightly as additional tree planting is proposed along the eastern boundary of Field G which will contribute to the layering of vegetation, filtering views of the development in Field G when viewed from the road and properties to the east. Proposed hedgerow across Field H has been removed to retain a larger Field, which will be beneficial to ongoing agricultural uses.

Drainage

Comments:

- *'Space should be provided for an attenuation feature, such as a basin'*

An attenuation basin (6000m² in area) has been added to Field C, positioned along the southern boundary. A species rich grassland seed mix is proposed within the basin which is tolerant of being seasonally wet.

Changes to the Assessment of Visual Effects

Due to the scale of reduction in the PV array and associated changes to the mitigation, the levels of visual effects recorded within the Landscape and Visual Impact Assessment (16th December 2021, Revision FV2) have changed. Changes are outlined below.

Views from the road between Westhide and Withington (Viewpoints 1 and 2)

In views heading east along the road (Viewpoint 1), the PV array will no longer be visible due to the removal of panels in the Fields, A, D and E. Construction of the access track along the boundary of Fields D and E, any mitigation planting or ongoing maintenance will be barely discernible. The magnitude of change is now assessed to be **Negligible** and the levels of effects are reduced to **Negligible adverse** for all stages.

In views heading west from Westhide (Viewpoint 2) and from nearby private properties, the PV array will no longer be present in Fields A, D and E. The PV array will be visible in the more distant Fields C and F with the substation to the south-east corner of Field C. Although this is a notable reduction in the extent of the PV array, it will still be a notable addition in views from the road. The visual effects, therefore, remain as **Moderate adverse**. After 15 years, maturing tree planting along the boundaries of Fields A, D, C and F, will create layers of vegetation which will heavily filter views of the PV array to the extent that the development will be barely discernible. The visual effects will be reduced to **Negligible adverse**.

Views from Westhide (Viewpoints 3 and 4)

The assessment of visual effects on views from PRoW WS1 to the south of Westhide (Viewpoint 3), will not alter. The visual effects remain as **Negligible adverse** for all stages.

No part of the PV array will now be visible in views from the churchyard (Viewpoint 4). Construction of the access track up to Field G, any mitigation planting or ongoing maintenance will be below levels of perception. Therefore, the magnitude of change and visual effects are now assessed as **No change**.

Views from the road at Kymin (Viewpoint 5)

In the glimpsed views from the road and in views from nearby private properties, the extent of the PV array visible will be reduced by the removal of panels from Fields H and I. However, the panels on the higher ground of Field G will remain a noticeable feature in views and the visual effects remain as **Minor adverse** during construction and at completion. The layers of mitigation planting remain as previously proposed and, therefore, the visual effects after 15 years remain as **Negligible adverse**.

Views from Withington (Viewpoints 6 - 8)

The extent of PV development visible in views from PRoW WT31 (Viewpoint 6), near Withington Court, will be considerably reduced by the removal of panels in Fields A, D and E. Due to intervening woodland, the PV array in Field C will be obscured from view and only a portion of the PV array in Field F will be visible. In the context of the long distance, panoramic views afforded from this footpath, the visible extent of the development will form only a small part and will be of a similar scale and appearance to the poly tunnels already present in the landscape. During construction and on completion, the magnitude of change is now assessed to be **Low** and the visual effects are now assessed as a **Minor adverse**, reducing to **Negligible adverse** on maturity of the mitigation tree planting proposed along the southern boundary of Field F.

No part of the PV array will not be visible in views from the grounds of the Church of St Peter (Viewpoint 7) or from the elevated PRoW WT10 (Viewpoint 8), south-west of the site. Any construction work, mitigation planting or ongoing maintenance will be below levels of perception. Therefore, the magnitude of change and visual effects are now assessed as **No change**.

Views from the north (Viewpoints 9 - 13)

In the brief view from the Three Choirs Way long distance footpath, near Thing Hill Court (Viewpoint 9), the PV array will no longer be visible in Field D. The remaining small portion of the PV array in Field F will be barely perceptible. Therefore, the visual effects are now assessed as **Negligible adverse**.

The assessment of visual effects on views from the long-distance footpath, where it passes Old Mokton (Viewpoint 10) and on higher ground further to the north-east (Viewpoint 11), will not alter. The visual effects remain as **Minor adverse** for all stages. Views from PRoW OP8#1 and PRoW PW9, remain as **No change**.

Changes to the Assessment of Landscape Effects

LCT Estate Farmlands

With the removal of panels from Fields A, D, E H and I, the PV array will now only be introduced into a single field (Field G) within the LCT Estate Farmlands. The northern part of Field G, in

which the PV array will be located, is relatively well contained from the wider landscape of the LCT and neighbouring LCT's by the mature trees to the north and west, and by its north facing slope, with limited visibility from surrounding roads, footpaths and settlement to the south and east. The addition of this PV array within this lightly settled, rural LCT would result in only the small and temporary loss of an agricultural field. During construction and on completion, the magnitude of change to the landscape is now assessed as **Low adverse**, and the landscape effects as **Minor adverse**.

On maturity of proposed hedgerow and tree planting along the boundaries of Field G, the PV array would become barely perceptible within the LCT. New hedgerow planting around Fields A, D, E and G will strengthen the local character of 'medium to large fields defined by hedgerows' and restore historic field patterns. At year 15, the landscape effects are now assessed to be **Negligible adverse**.

LCT Riverside Meadows

AS per the previous LVIA assessment, there is PV development present across Fields C and F, and, therefore, the landscape effects on the LCT Riverside Meadows remain as **Minor adverse**.

LCT Principal Settled Farmland

Although the scale of the development has reduced, there will still be small amount of inter-visibility from the north-east edge of the LCT around Withington (as demonstrated by Viewpoint 6). The landscape effects remain as **Negligible adverse**.

Site and Immediate Surroundings

The new proposals will result in the long term, but reversible, loss of only three of the eight agricultural fields within the site. As previously described, Field G is relatively well contained from the wider landscape by vegetation and landform. Fields C and F are also well contained by mature woodland and hedgerows, with some inter-visibility with the wider landscape to the south. As before, the majority of landscape features will be unaffected by the development and the proposals will introduce mitigation measures which enhance local green infrastructure corridors, restores historic field patterns and reinforces local landscape character. Therefore, the development will result in the temporary loss of a low number of localised landscape features. The magnitude of change to the landscape is now assessed as **Low adverse**, and the landscape effects as **Minor adverse**.

Conclusion

As a result of the reduction in panels in Fields A, D, E, H and I, the proposed development will still result in some limited adverse effects however lower than those previously assessed within the LVIA. All landscape and visual effects are reduced to **Minor adverse** or lower, except for views from the road heading west from Westside (Viewpoint 2). During construction and completion, visual effects from the road are assessed as **Moderate adverse**, reducing to **Negligible adverse** on maturity of mitigation planting.

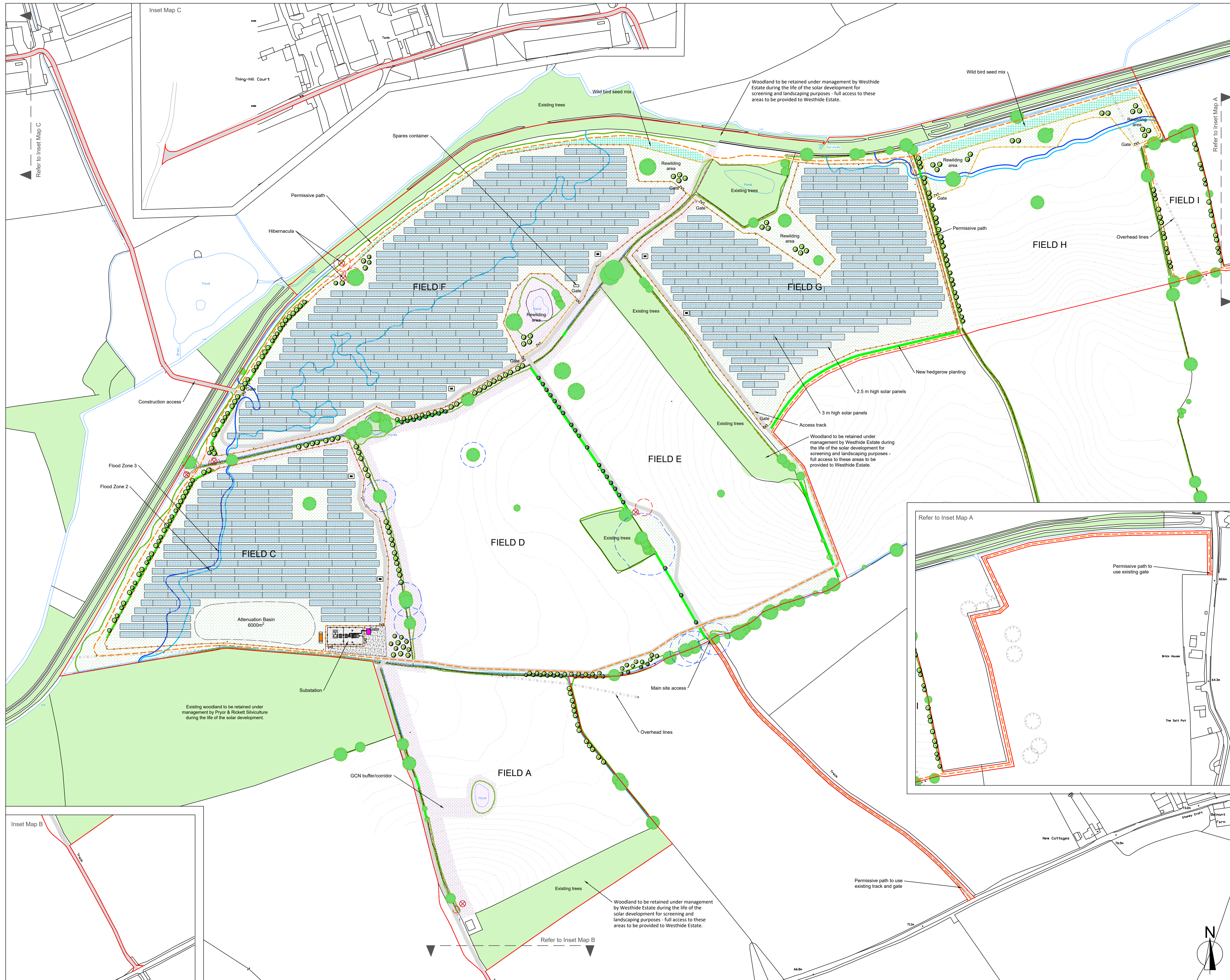

- GENERAL NOTES:**
1. ALL DIMENSIONS AND LEVELS SHALL BE CHECKED ON SITE PRIOR TO CONSTRUCTION WORK COMMENCING.
 2. ALL LANDSCAPE DRAWINGS TO BE READ IN CONJUNCTION WITH ALL RELEVANT ENGINEER'S AND ARCHITECT'S DRAWINGS AND SPECIFICATIONS.
 3. ALL DRAWINGS TO BE READ IN CONJUNCTION WITH THE LANDSCAPE SPECIFICATION.
 4. ANY DISCREPANCY CONCERNING THE DRAWINGS SHOULD BE REFERRED TO THE CA IMMEDIATELY.
 5. ALL DIMENSIONS IN MILLIMETRES UNLESS NOTED OTHERWISE.
 6. ALL LEVELS IN METRES.
 7. DO NOT SCALE OFF THIS DRAWING.
 8. EXISTING SERVICE ALIGNMENTS SHALL BE CHECKED ON SITE BY THE CONTRACTOR PRIOR TO CONSTRUCTION WORK COMMENCING.

Legend

- Site boundary
- Existing woodland
- Existing tree (surveyed)
- Existing hedgerow (surveyed) all to be retained and enhanced to 3m high winter cut height
- Existing overhead utility/electricity lines (surveyed)
- Existing water course / pond
- Existing tree planting retained and enhanced
- Buffer zone for ancient and veteran trees
- Flood zone 2
- Flood zone 3

Proposed

- Proposed tree planting (indicative - refer to Landscape Mitigation and Enhancement Plans)
- Poor quality trees to be removed (please refer to arb survey, dwg # 210409-WSS-SP-AM)
- New species-rich hedgerow planting
- Proposed species-rich grassland
- Proposed wild bird seed mix grassland (0.5 ha total)
- Great Crested Newt (GCN) ecological buffer
- Hibernacula
- 2.5 m high post and wire fencing to have manual gates for manual access
- 2.4 m high palisade fencing (around DNO customer substation)
- 1.2 m high timber post and rail fencing (to rewinding areas)
- Access track
- CCTV camera
- Inverter transformer unit
- DNO switch housing
- Customer substation
- Substation handstanding
- Proposed solar panels 2.5 m high
- Proposed solar panels 3 m high
- Permissive path

DRAWING NOTES:

Field G to have 2.5 m high solar panels along the southern edge. 3m high solar panels to be used elsewhere.

During the design development process Field B was removed from the proposals and, therefore, it is not shown or referred to on the Masterplan.

Rev.	Date:	Description:	Drawn	Ch'd
A	21/09/2021	Ecology and landscape additions as per comments	GS	JH
B	04/10/2021	Site access and permitted path amended as per comments	GS	JH
C	07/11/2021	Contours added	GS	JH
D	16/11/2021	Substation relocated and redline boundary updated. Minor amendments as per comments	JH	AS
E	18/11/2021	Redline boundary update	JH	AS
F	23/11/2021	Redline boundary update	JH	AS
G	14/06/2022	Updates as per local authority comments	JH	AS
H	20/06/2022	Minor amendments as per comments	JH	AS
I	23/06/2022	Amendments to GCN corridor	JH	AS
J	26/09/2022	Removal of panels in Fields H and I	JH	AS
K	27/09/2022	Updated mitigation and permissive path	JH	AS
L	11/10/2022	Removal of panels in Fields A, D and E	JH	AS
M	18/10/2022	Updated panel layout	JH	AS
N	18/10/2022	Updated panel layout	JH	AS
O	20/10/2022	Updated panel layout - Attenuation basin added	JH	AS

THE Landmark PRACTICE

1 Theynes Court
Long Ashton Business Park
Yanley Lane
Bristol BS41 9LB
United Kingdom

Tel: +44 (0)117 923 0455
enquiries@thelandmarkpractice.com
www.thelandmarkpractice.com

CLIENT
ERSUN (WESTHIDE SPV) LTD

PROJECT
WESTHIDE SOLAR

TITLE
MASTERPLAN

Status: PLANNING	Drawn: GS	Checked: JH
Scale: 1:2,000@A1	Date: 20.07.21	Approved: GM

Drawing Number: 3352_L_GA_0_01

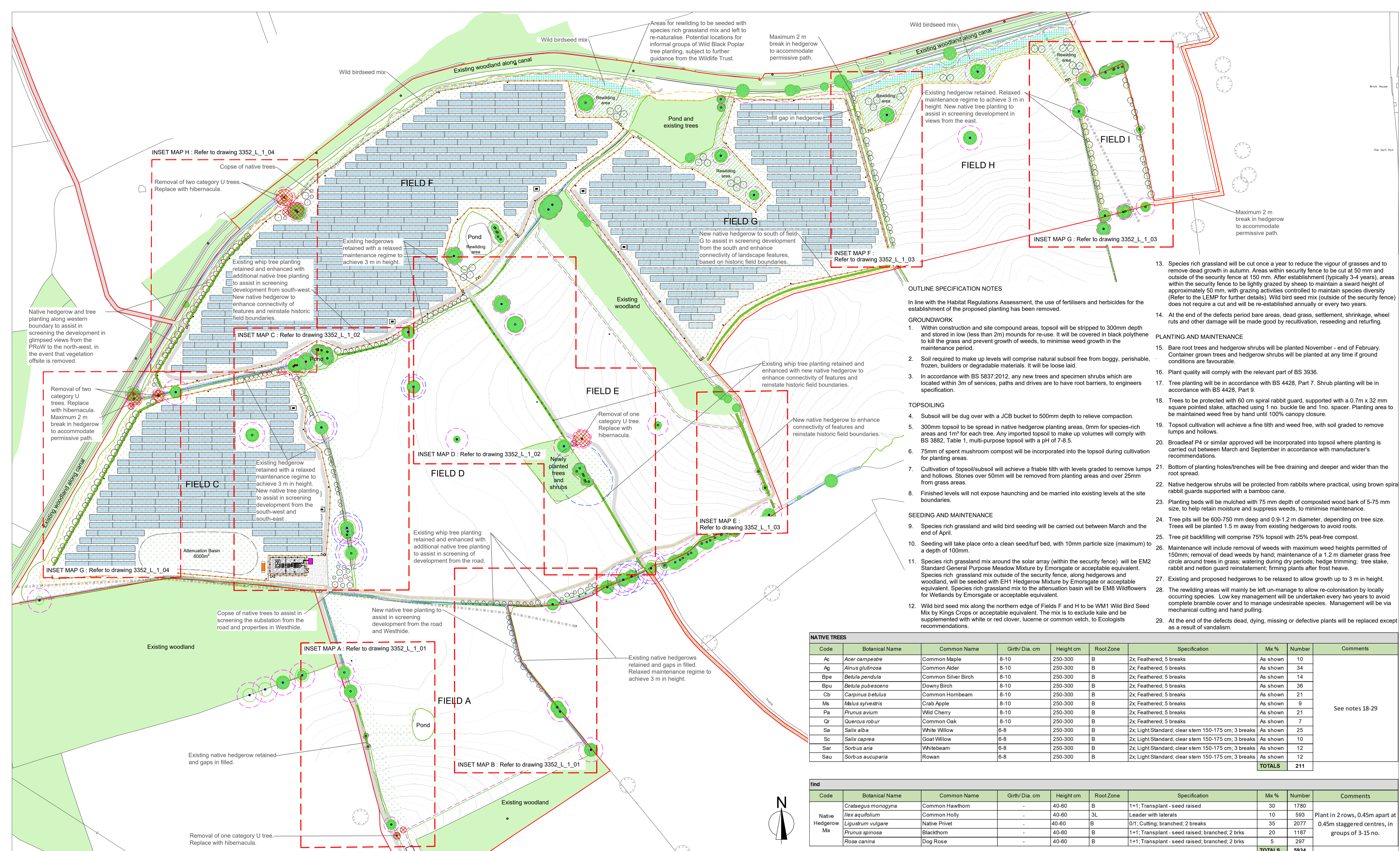

OUTLINE SPECIFICATION NOTES

In line with the Habitat Regulations Assessment, the use of fertilisers and herbicides for the establishment of the proposed planting has been removed.

GROUNDWORK

1. Within construction and site compound areas, topsoil will be stripped to 300mm depth and stored in low (less than 2m) mounds for re-use. It will be covered in black polythene to kill the grass and prevent growth of weeds, to minimise weed growth in the maintenance period.
2. Soil required to make up levels will comprise natural subsoil free from boggy, perishable, frozen, builders or degradable materials. It will be loose laid.
3. In accordance with BS 5837:2012, any new trees and specimen shrubs which are located within 3m of services, paths and drives are to have root barriers, to engineers specification.

TOPSOILING

4. Subsoil will be dug over with a JCB bucket to 500mm depth to relieve compaction.
5. 300mm topsoil to be spread in native hedgerow planting areas, 0mm for species-rich areas and 1m² for each tree. Any imported topsoil to make up volumes will comply with BS 3882, Table 1, multi-purpose topsoil with a pH of 7-8.5.
6. 75mm of spent mushroom compost will be incorporated into the topsoil during cultivation for planting areas.
7. Cultivation of topsoil/subsoil will achieve a friable tilth with levels graded to remove lumps and hollows. Stones over 50mm will be removed from planting areas and over 25mm from grass areas.
8. Finished levels will not expose haunching and be married into existing levels at the site boundaries.

SEEDING AND MAINTENANCE

9. Species rich grassland and wild bird seeding will be carried out between March and the end of April.
10. Seeding will take place onto a clean seed/turf bed, with 10mm particle size (maximum) to a depth of 100mm.
11. Species rich grassland mix around the solar array (within the security fence) will be EM2 Standard General Purpose Meadow Mixture by Emorsgate or acceptable equivalent. Species rich grassland mix outside of the security fence, along hedgerows and woodland, will be seeded with EH1 Hedgerow Mixture by Emorsgate or acceptable equivalent. Species rich grassland mix to the attenuation basin will be EM8 Wildflowers for Wetlands by Emorsgate or acceptable equivalent.
12. Wild bird seed mix along the northern edge of Fields F and H to be WM1 Wild Bird Seed Mix by Kings Crops or acceptable equivalent. The mix is to exclude kale and be supplemented with white or red clover, lucerne or common vetch, to Ecologists recommendations.

13. Species rich grassland will be cut once a year to reduce the vigour of grasses and to remove dead growth in autumn. Areas within security fence to be cut at 50 mm and outside of the security fence to be lightly grazed by sheep to maintain a sward height of approximately 50 mm, with grazing activities controlled to maintain species diversity (Refer to the LEMP for further details). Wild bird seed mix (outside of the security fence) does not require a cut and will be re-established annually or every two years.
14. At the end of the defects period bare areas, dead grass, settlement, shrinkage, wheel ruts and other damage will be made good by recultivation, reseeding and returning.

PLANTING AND MAINTENANCE

15. Bare root trees and hedgerow shrubs will be planted November - end of February. Container grown trees and hedgerow shrubs will be planted at any time if ground conditions are favourable.
16. Plant quality will comply with the relevant part of BS 3936.
17. Tree planting will be in accordance with BS 4428, Part 7. Shrub planting will be in accordance with BS 4428, Part 9.
18. Trees to be protected with 60 cm spiral rabbit guard, supported with a 0.7m x 32 mm square pointed stake, attached using 1 no. buckle tie and 1 no. spacer. Planting area to be maintained weed free by hand until 100% canopy closure.
19. Topsoil cultivation will achieve a fine tilth and weed free, with soil graded to remove lumps and hollows.
20. Broadleaf P4 or similar approved will be incorporated into topsoil where planting is carried out between March and September in accordance with manufacturer's recommendations.
21. Bottom of planting holes/trenches will be free draining and deeper and wider than the root spread.
22. Native hedgerow shrubs will be protected from rabbits where practical, using brown spiral rabbit guards supported with a bamboo cane.
23. Planting beds will be mulched with 75 mm depth of composted wood bark of 5-75 mm size, to help retain moisture and suppress weeds, to minimise maintenance.
24. Tree pits will be 600-750 mm deep and 0.9-1.2 m diameter, depending on tree size. Trees will be planted 1.5 m away from existing hedgerows to avoid roots.
25. Tree pit backfilling will comprise 75% topsoil with 25% peat-free compost.
26. Maintenance will include removal of weeds with maximum weed heights permitted of 150mm; removal of dead weeds by hand; maintenance of a 1.2 m diameter grass free circle around trees in grass; watering during dry periods; hedge trimming; tree stake, rabbit and neton guard reinstatement; firming plants after frost heave.
27. Existing and proposed hedgerows to be relaxed to allow growth up to 3 m in height.
28. The rewilding areas will mainly be left un-managed to allow re-colonisation by locally occurring species. Low key management will be undertaken every two years to avoid complete bramble cover and to manage undesirable species. Management will be via mechanical cutting and hand pulling.
29. At the end of the defects dead, dying, missing or defective plants will be replaced except as a result of vandalism.

Code	Botanical Name	Common Name	Girth/ Dia. cm	Height cm	Root Zone	Specification	Mix %	Number	Comments
Ac	<i>Acer campestre</i>	Common Maple	8-10	250-300	B	2x; Feathered; 5 breaks	As shown	10	
Ag	<i>Alnus glutinosa</i>	Common Alder	8-10	250-300	B	2x; Feathered; 5 breaks	As shown	34	
Bpe	<i>Betula pendula</i>	Common Silver Birch	8-10	250-300	B	2x; Feathered; 5 breaks	As shown	14	
Bpu	<i>Betula pubescens</i>	Downy Birch	8-10	250-300	B	2x; Feathered; 5 breaks	As shown	36	
Cb	<i>Carpinus betulus</i>	Common Hornbeam	8-10	250-300	B	2x; Feathered; 5 breaks	As shown	21	
Ms	<i>Malus sylvestris</i>	Crab Apple	8-10	250-300	B	2x; Feathered; 5 breaks	As shown	9	
Pa	<i>Prunus avium</i>	Wild Cherry	8-10	250-300	B	2x; Feathered; 5 breaks	As shown	21	
Qr	<i>Quercus robur</i>	Common Oak	8-10	250-300	B	2x; Feathered; 5 breaks	As shown	7	
Sc	<i>Salix alba</i>	White Willow	6-8	250-300	B	2x; Light Standard; clear stem 150-175 cm; 3 breaks	As shown	25	
Sa	<i>Salix caprea</i>	Goat Willow	6-8	250-300	B	2x; Light Standard; clear stem 150-175 cm; 3 breaks	As shown	10	
Sar	<i>Sorbus aria</i>	Whitebeam	6-8	250-300	B	2x; Light Standard; clear stem 150-175 cm; 3 breaks	As shown	12	
Sau	<i>Sorbus aucuparia</i>	Rowan	6-8	250-300	B	2x; Light Standard; clear stem 150-175 cm; 3 breaks	As shown	12	
TOTALS								211	

Code	Botanical Name	Common Name	Girth/ Dia. cm	Height cm	Root Zone	Specification	Mix %	Number	Comments
	<i>Crataegus monogyna</i>	Common Hawthorn	-	40-60	B	1+1; Transplant - seed raised	30	1780	
	<i>Ilex aquifolium</i>	Common Holly	-	40-60	3L	Leader with laterals	10	593	Plant in 2 rows, 0.45m apart at 0.45m staggered centres, in groups of 3-15 no.
	<i>Ligustrum vulgare</i>	Native Privet	-	40-60	B	0/1; Cutting; branched; 2 breaks	35	2077	
	<i>Prunus spinosa</i>	Blackthorn	-	40-60	B	1+1; Transplant - seed raised; branched; 2 brks	20	1187	
	<i>Rosa canina</i>	Dog Rose	-	40-60	B	1+1; Transplant - seed raised; branched; 2 brks	5	297	
TOTALS								5934	

Reproduced with the permission of the controller of her Majesty's Stationery Office. © Crown Copyright - Licence No. AR100017235

- GENERAL NOTES:**
1. ALL DIMENSIONS AND LEVELS SHALL BE CHECKED ON SITE PRIOR TO CONSTRUCTION WORK COMMENCING.
 2. ALL LANDSCAPE DRAWINGS TO BE READ IN CONJUNCTION WITH ALL RELEVANT ENGINEER'S AND ARCHITECT'S DRAWINGS AND SPECIFICATIONS.
 3. ALL DRAWINGS TO BE READ IN CONJUNCTION WITH THE LANDSCAPE SPECIFICATION.
 4. ANY DISCREPANCY CONCERNING THE DRAWINGS SHOULD BE REFERRED TO THE CA IMMEDIATELY.
 5. ALL DIMENSIONS IN MILLIMETRES UNLESS NOTED OTHERWISE.
 6. ALL LEVELS IN METRES.
 7. DO NOT SCALE OFF THIS DRAWING.
 8. EXISTING SERVICE ALIGNMENTS SHALL BE CHECKED ON SITE BY THE CONTRACTOR PRIOR TO CONSTRUCTION WORK COMMENCING.

- KEY:**
- Site boundary
 - Permissive footpath
 - Existing overhead utility/electricity lines
 - Proposed solar panels 2.5m high refer to drawing 3352_P_DT_3_01
 - Proposed solar panels 3m high refer to drawing 3352_P_DT_3_01
 - Proposed DNO switch housing
 - Proposed customer substation
 - Proposed inverter transformer unit
 - Existing woodland
 - Existing tree (surveyed) refer to arboricultural survey by Hillside Trees
 - Existing tree (not surveyed) for context
 - Existing tree to be removed - Category U refer to note 12
 - Buffer zone for ancient and veteran trees
 - Existing whip tree planting Based on topographical survey and field survey
 - Existing hedgerow Based on topographical survey
 - Proposed species-rich hedgerow planting refer to plant schedule
 - Proposed tree planting - shown at approximate 25 year canopy spread, refer to plant schedule
 - Proposed species-rich grassland refer to note 11
 - Proposed wild bird seed mix grassland (0.5 ha total) refer to note 12
 - Hibernacula

- Hardworks**
- Proposed access track refer to drawing 3352_P_DT_3_04
 - Proposed 3 m high CCTV camera refer to drawing 3352_P_DT_3_03
 - Proposed 2.5 m high post and wire security fencing refer to drawing 3352_P_DT_3_02
 - 1.2 m high timber post and rail fencing (to rewilding areas)
 - Proposed steel palisade security fencing - 2.4 m high (around DNO customer substation) Finish: Powder coated, matt finish, Colour: Green RAL 6005 Moss Green
 - Proposed substation hardstanding to engineers specification

- DRAWING NOTES:**
- To be read in conjunction with:
- 3352_L_GA_0_01 Masterplan
 - 3352_L_GA_1_01 Landscape Mitigation and Enhancement Plan Inset 1 of 3
 - 3352_L_GA_1_02 Landscape Mitigation and Enhancement Plan Inset 2 of 3
 - 3352_L_GA_1_03 Landscape Mitigation and Enhancement Plan Inset 3 of 3
 - 3352_L_GA_1_04 Landscape Mitigation and Enhancement Plan Inset 4 of 4
 - 3352_P_DT_3_01 PV Mounting System Detail
 - 3352_P_DT_3_02 Fence and Gate Detail
 - 3352_P_DT_3_03 CCTV Detail
 - 3352_P_DT_3_04 Access Tracks Detail
 - 3352_P_DT_3_05 Transformer Substation Detail
 - 3352_P_DT_3_06 Inverter Detail
 - 3352_P_DT_3_07 Spares Container Detail
 - 3352_LEMP Landscape and Ecological Management Plan

Rev.	Date	Description	Drawn	Ch'd
A	09/12/2021	Minor amendments	JH	AS
B	16/12/2021	Updated drawing notes	JH	AS
C	17/06/2022	Updated proposals to respond to comments from the local authority	JH	AS
D	23/06/2022	Updated specification notes - removal of fertilisers and herbicides	JH	AS
E	20/10/2022	Removal of panels in Fields A, D, E, H and I. Mitigation revised to suit	JH	AS

THE Landmark PRACTICE

1 Theynes Court
Long Ashton Business Park
Yanley Lane
Bristol BS41 9LB
United Kingdom

Tel: +44 (0)117 923 0455
enquiries@thelandmarkpractice.com
www.thelandmarkpractice.com

Environmental Planning EIA Landscape Architecture Ecology

CLIENT
ERSUN (WESTHIDE SPV) LTD

PROJECT
WESTHIDE SOLAR

TITLE
LANDSCAPE MITIGATION AND ENHANCEMENT PLAN

Status: PLANNING	Drawn: JH	Checked: LF
Scale: 1:2000@A1	Date: 03.12.2021	Approved: AS
Drawing Number: 3352_L_GA_0_02	Rev: E	

S:\PROJECTS\3350 - 3399\3352 - Westhild Solar\GRAPHIC\CAD\PILOT FILES

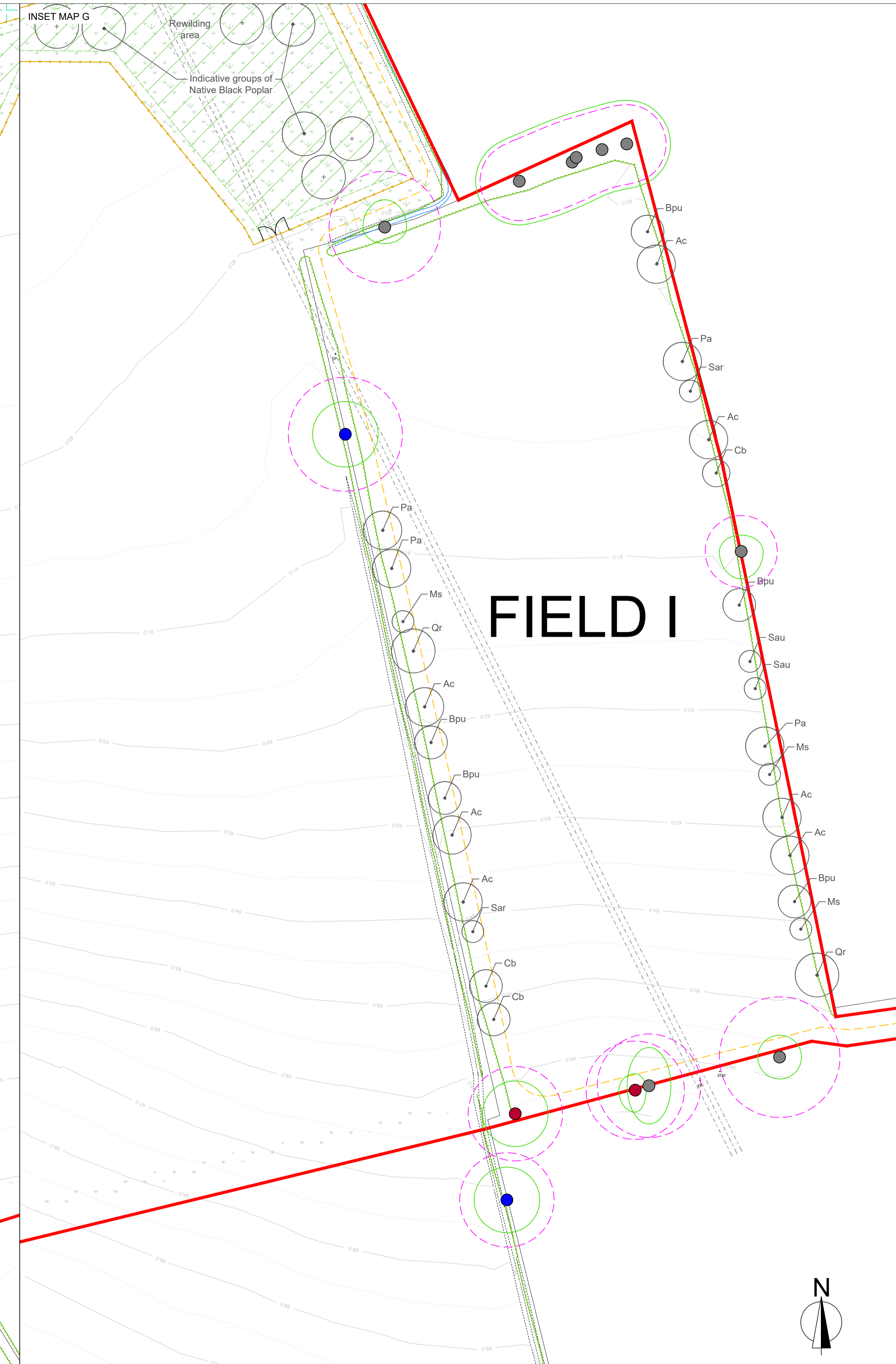
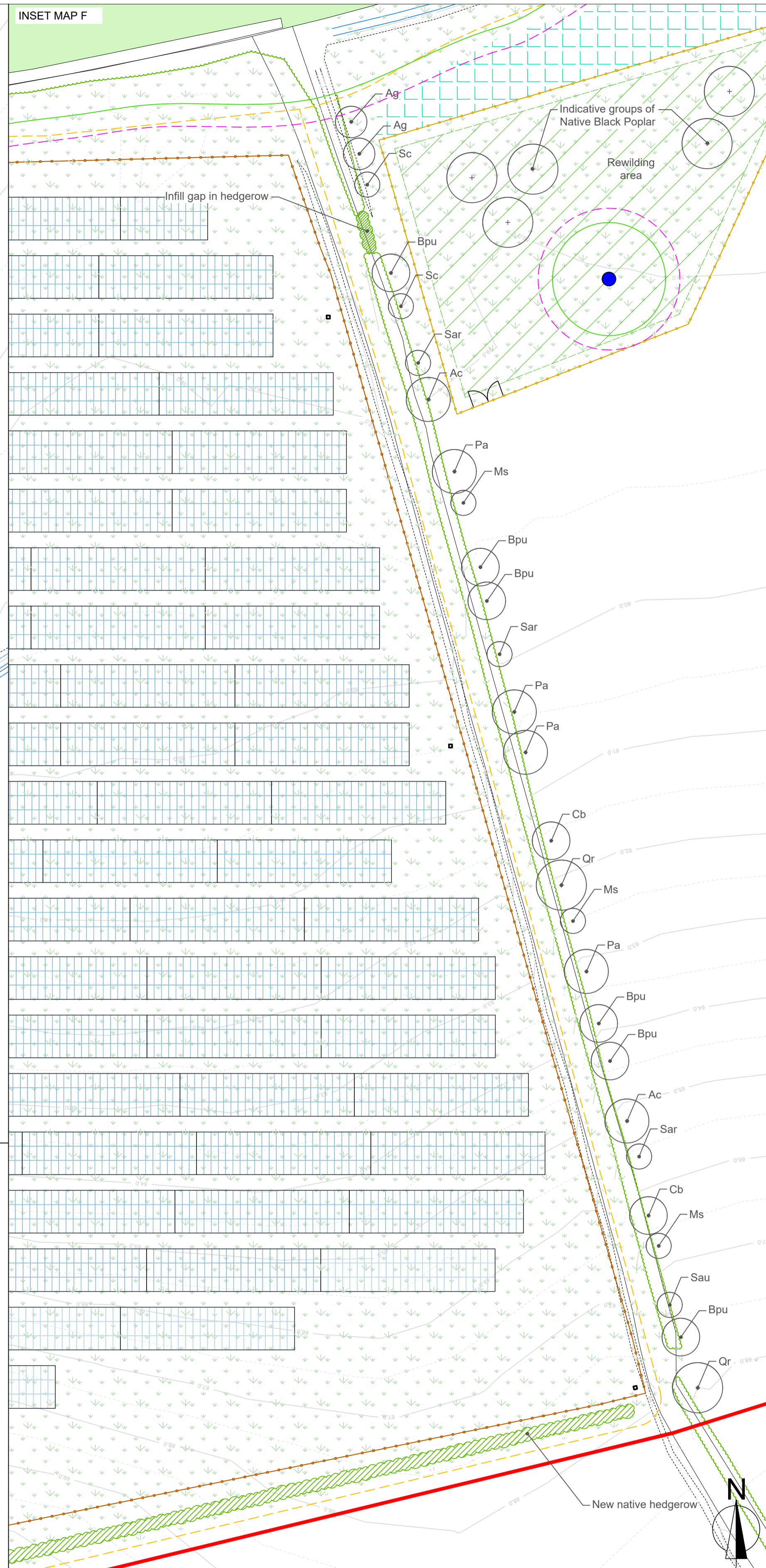
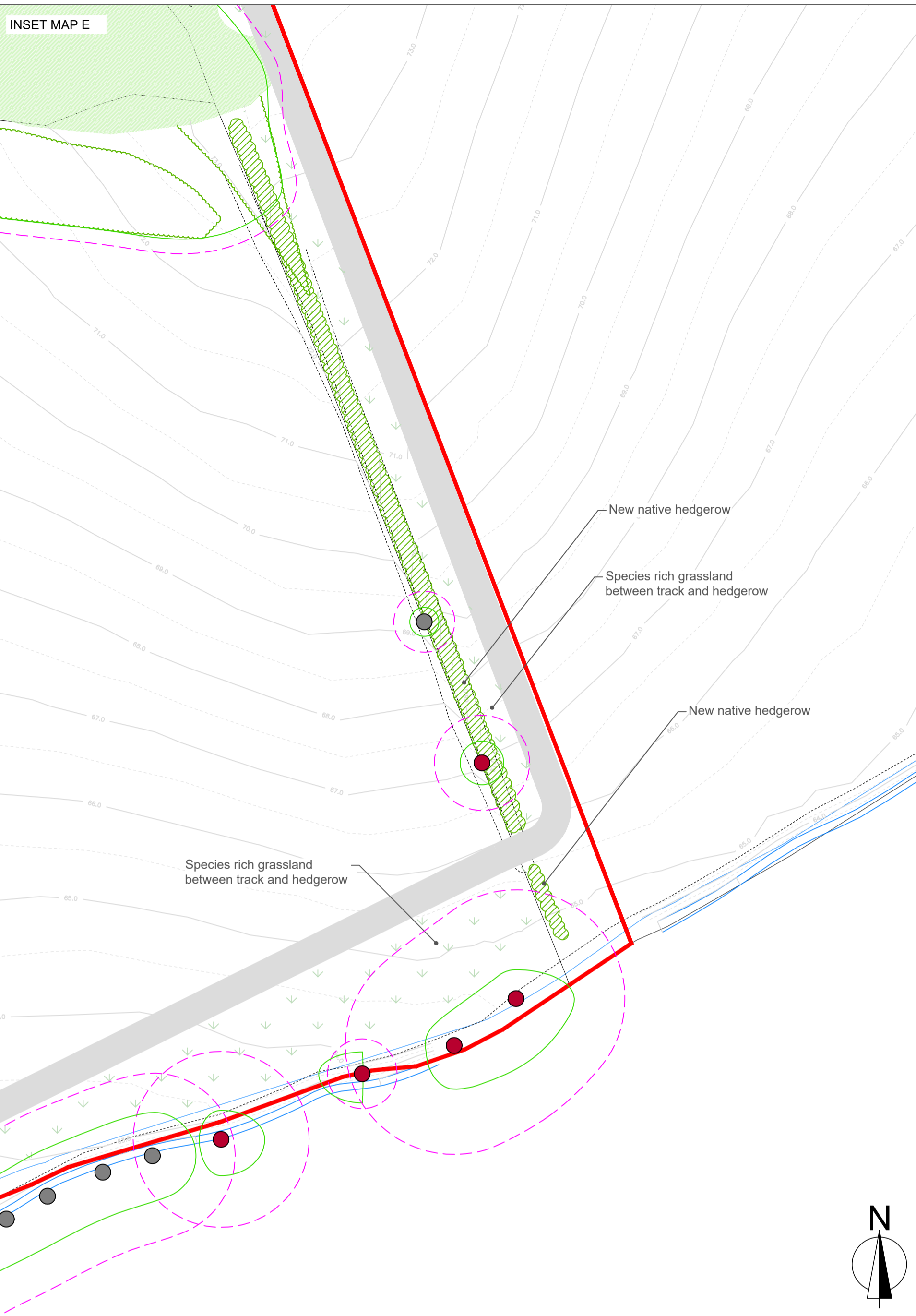

Reproduced with the permission of the controller of her Majesty's Stationery Office. © Crown Copyright - Licence No. AR100017235

GENERAL NOTES:

1. ALL DIMENSIONS AND LEVELS SHALL BE CHECKED ON SITE PRIOR TO CONSTRUCTION WORK COMMENCING.
2. ALL LANDSCAPE DRAWINGS TO BE READ IN CONJUNCTION WITH ALL RELEVANT ENGINEER'S AND ARCHITECT'S DRAWINGS AND SPECIFICATIONS.
3. ALL DRAWINGS TO BE READ IN CONJUNCTION WITH THE LANDSCAPE SPECIFICATION.
4. ANY DISCREPANCY CONCERNING THE DRAWINGS SHOULD BE REFERRED TO THE CA IMMEDIATELY.
5. ALL DIMENSIONS IN MILLIMETRES UNLESS NOTED OTHERWISE.
6. ALL LEVELS IN METRES.
7. DO NOT SCALE OFF THIS DRAWING.
8. EXISTING SERVICE ALIGNMENTS SHALL BE CHECKED ON SITE BY THE CONTRACTOR PRIOR TO CONSTRUCTION WORK COMMENCING.

DRAWING NOTES:

To be read in conjunction with drawings:

- 3352_L_GA_0_01 Masterplan
- 3352_L_GA_0_02 Landscape Mitigation and Enhancement Plan
- 3352_L_GA_1_01 Landscape Mitigation and Enhancement Plan Inset 1 of 4
- 3352_L_GA_1_02 Landscape Mitigation and Enhancement Plan Inset 2 of 4
- 3352_L_GA_1_04 Landscape Mitigation and Enhancement Plan Inset 4 of 4

and report

- 3352_LEMP Landscape and Ecological Management Plan

Rev:	Date:	Description:	Drawn	Ch'd
A	17/06/2022	Updated proposals to respond to comments from the local authority	JH	AS
B	20/10/2022	Panels removed from Fields A, D, E, H and I. Mitigation planting revised to suit.	JH	AS

THE Landmark PRACTICE

1 Theynes Court
Long Ashton Business Park
Yanley Lane
Bristol BS41 9LB
United Kingdom

Tel: +44 (0)117 923 0455

enquiries@thelandmarkpractice.com
www.thelandmarkpractice.com

CLIENT ERSUN (WESTHIDE SPV) LTD		
PROJECT WESTHIDE SOLAR		
TITLE LANDSCAPE MITIGATION AND ENHANCEMENT PLAN - INSET 3 OF 4		
Status: PLANNING	Drawn: JH	Checked: LF
Scale: 1:2,000@A1	Date: 03.12.2021	Approved: AS
Drawing Number: 3352_L_GA_1_03		Rev: B

Environmental Planning EIA Landscape Architecture Ecology

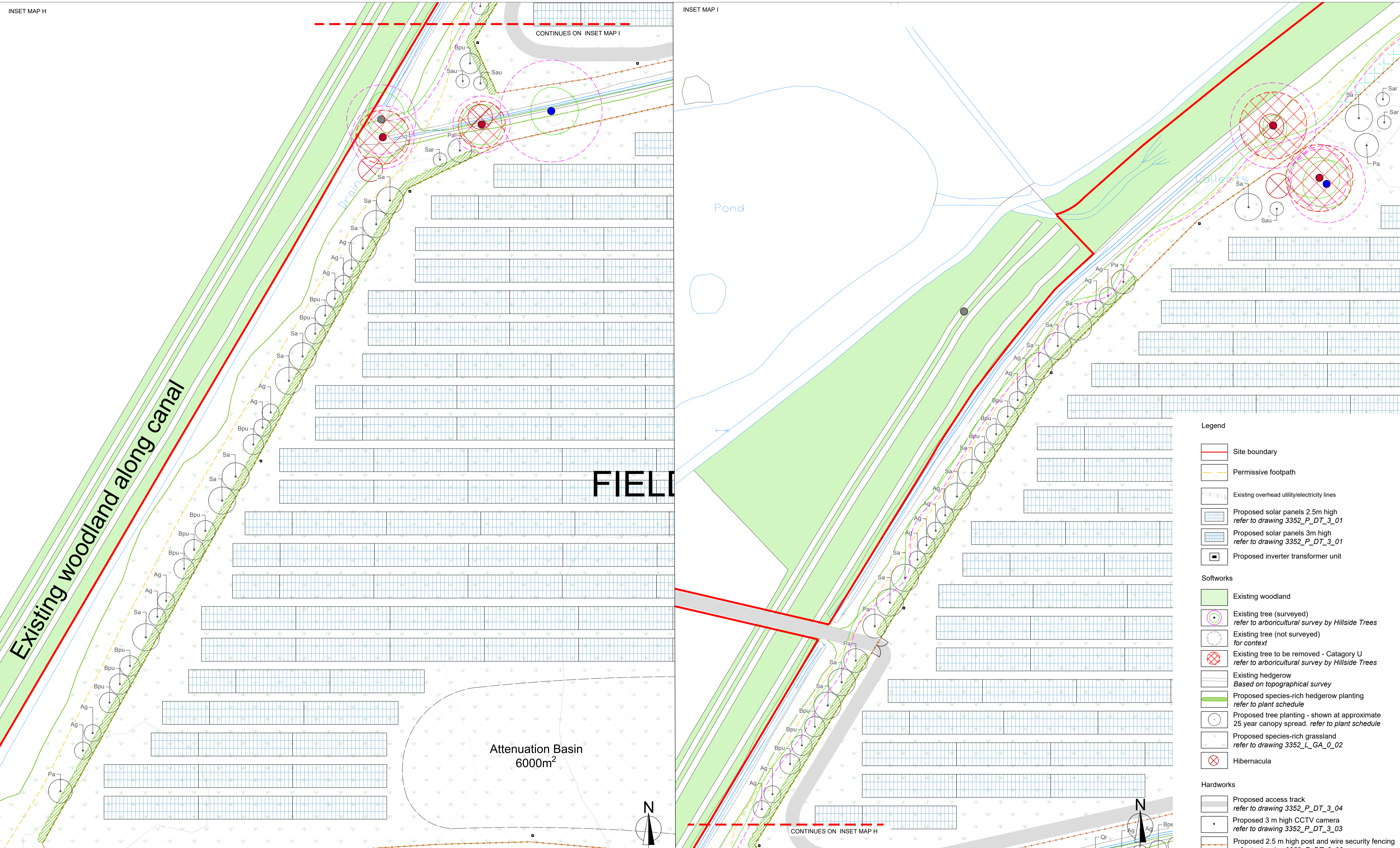

- Legend**
- Site boundary
 - Permissive footpath
 - Existing overhead utility/electricity lines
 - Proposed solar panels 2.5m high refer to drawing 3352_P_DT_3_01
 - Proposed solar panels 3m high refer to drawing 3352_P_DT_3_01
 - Proposed inverter transformer unit
- Softworks**
- Existing woodland
 - Existing tree (surveyed) refer to arboricultural survey by Hillside Trees
 - Existing tree (not surveyed) for context
 - Existing tree to be removed - Category U refer to arboricultural survey by Hillside Trees
 - Existing hedgerow Based on topographical survey
 - Proposed species-rich hedgerow planting refer to plant schedule
 - Proposed tree planting - shown at approximate 25 year canopy spread. refer to plant schedule
 - Proposed species-rich grassland refer to drawing 3352_L_GA_0_02
 - Hibernacula
- Hardworks**
- Proposed access track refer to drawing 3352_P_DT_3_04
 - Proposed 3 m high CCTV camera refer to drawing 3352_P_DT_3_03
 - Proposed 2.5 m high post and wire security fencing refer to drawing 3352_P_DT_3_02

Reproduced with the permission of the controller of her Majesty's Stationery Office. © Crown Copyright - Licence No. AR100017235

GENERAL NOTES:

- ALL DIMENSIONS AND LEVELS SHALL BE CHECKED ON SITE PRIOR TO CONSTRUCTION WORK COMMENCING.
- ALL LANDSCAPE DRAWINGS TO BE READ IN CONJUNCTION WITH ALL RELEVANT ENGINEER'S AND ARCHITECT'S DRAWINGS AND SPECIFICATIONS.
- ALL DRAWINGS TO BE READ IN CONJUNCTION WITH THE LANDSCAPE SPECIFICATION.
- ANY DISCREPANCY CONCERNING THE DRAWINGS SHOULD BE REFERRED TO THE CA IMMEDIATELY.
- ALL DIMENSIONS IN MILLIMETRES UNLESS NOTED OTHERWISE.
- ALL LEVELS IN METRES.
- DO NOT SCALE OFF THIS DRAWING.
- EXISTING SERVICE ALIGNMENTS SHALL BE CHECKED ON SITE BY THE CONTRACTOR PRIOR TO CONSTRUCTION WORK COMMENCING.

DRAWING NOTES:

To be read in conjunction with drawings:

- 3352_L_GA_0_01 Masterplan
- 3352_L_GA_0_02 Landscape Mitigation and Enhancement Plan
- 3352_L_GA_1_01 Landscape Mitigation and Enhancement Plan Inset 1 of 4
- 3352_L_GA_1_02 Landscape Mitigation and Enhancement Plan Inset 2 of 4
- 3352_L_GA_1_03 Landscape Mitigation and Enhancement Plan Inset 3 of 4

and report

- 3352_LEMP Landscape and Ecological Management Plan

Rev:	Date:	Description:	Drawn:	Ch'd:
A	20/10/22	Panels removed from Fields A, D, E, H and I. Mitigation planting revised to suit.	JH	AS

Environmental Planning	EIA	Landscape Architecture	Ecology
------------------------	-----	------------------------	---------

THE Landmark PRACTICE

1 Theynes Court
Long Ashton Business Park
Yanley Lane
Bristol BS41 9LB
United Kingdom

Tel: +44 (0)117 923 0455

enquiries@thelandmarkpractice.com
www.thelandmarkpractice.com

CLIENT ERSUN (WESTHIDE SPV) LTD			
PROJECT WESTHIDE SOLAR			
TITLE LANDSCAPE MITIGATION AND ENHANCEMENT PLAN - INSET 4 OF 4			
Status: PLANNING	Drawn: JH	Checked: AS	Rev: A
Scale: 1:2,000@A1	Date: 17.06.2022	Approved: AS	
Drawing Number: 3352_L_GA_1_04			